



# No Utility Bills Inc.

[www.noutilitybills.com](http://www.noutilitybills.com)

Tel: (780)628-4835

#301 Lyall Subdivision, County of Athabasca, AB, Canada

VIEWINGS BY APPOINTMENT ONLY!

List Price From	
Sale Price From	
* Prices subject to change without notice!	

## Harman PF-100 Pellet Furnace



PF100 Pellet Furnace operating automatically to give you warm, comfortable temperatures throughout your home. Set the temperature dial on the wall mounted control to the desired setting. The PF100 will do the rest. If heat is required, the fire will automatically light and burn at the proper rate to produce just the right amount of heat. If heating demand is reduced, the PF100 will reduce the fire. If no heat is required, the fire will go out and light again when more heat is needed. When the fuel in the hopper gets low the red light on the wall control will blink, telling you to add fuel to the hopper.

Specifications	
Fuel	Bio-Mass Pellets
BTU Range	0 to 112,000
Heating Capacity	2,500 Square Feet
Hopper Capacity	160 lbs
Blower Size	1000 cfm
Flue Size	4" Pellet Vent Pipe
Outside Air Size	2.75 inches
Fuse Rating	10 amp
Weight	450 lbs
Depth	62.44 inches
Height	49.65 inches
Width	26 inches
Feed Rate	1 to 13 lbs per hour
Venting Type	Direct Vent
Testing	CAN/CSA B366.10-M91, UL 391, ASTM E 1509-95, ULC C1482-M1990

With the patented Harman feeder and burn pot, even high ash pellets can be burned efficiently.

The PF100 can be installed as a stand-alone hot air heating system or incorporated into existing hot air systems. A chimney is not required for venting. This direct vent system can also use outside air for combustion.

Dual heat exchangers are used to extract maximum heat from the fuel, which will save you money.

The PF100's huge ash pan allows two to three tons of pellets to be burned before emptying. The combustion blower design eliminates the need for a chimney and can be easily removed for annual cleaning. A shaker handle is used to clean the heat exchanger tubes. This is easy to do and is normally done when hopper is filled. The wall mounted temperature control allows you to set your desired temperature. The PF100 will do the rest.



# No Utility Bills Inc.

[www.noutilitybills.com](http://www.noutilitybills.com)

Tel: (780)628-4835

#301 Lyall Subdivision, County of Athabasca, AB, Canada

VIEWINGS BY APPOINTMENT ONLY!

## Harman PF-100 Pellet Furnace

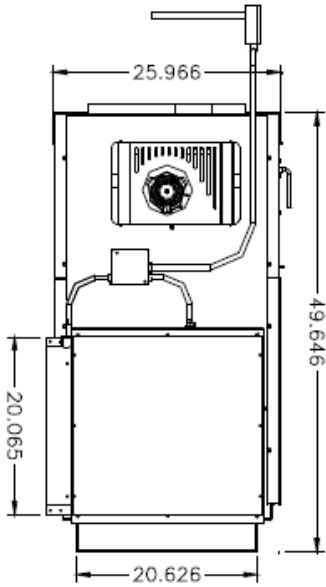

**Back View**

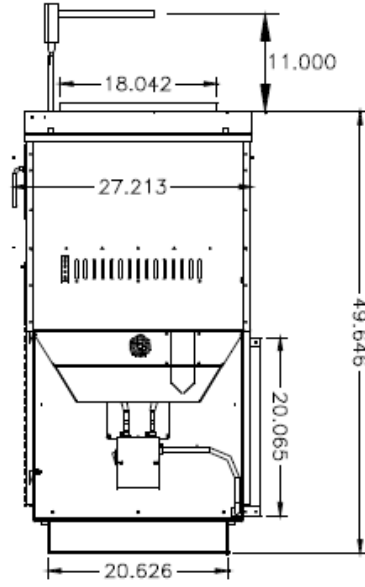

**Front View**

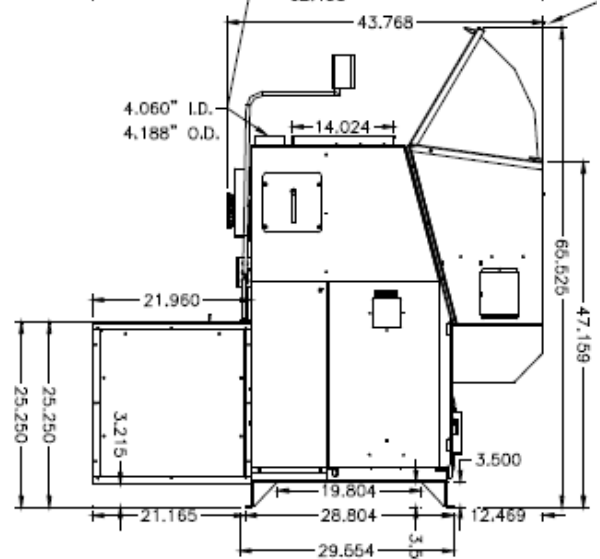
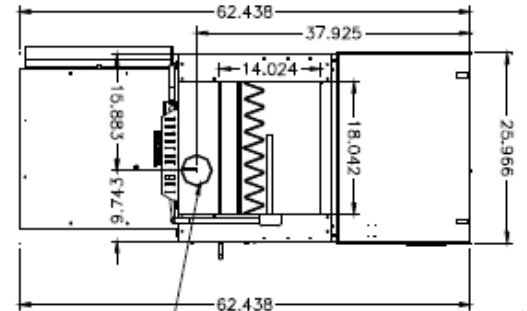

**Side / Top View**

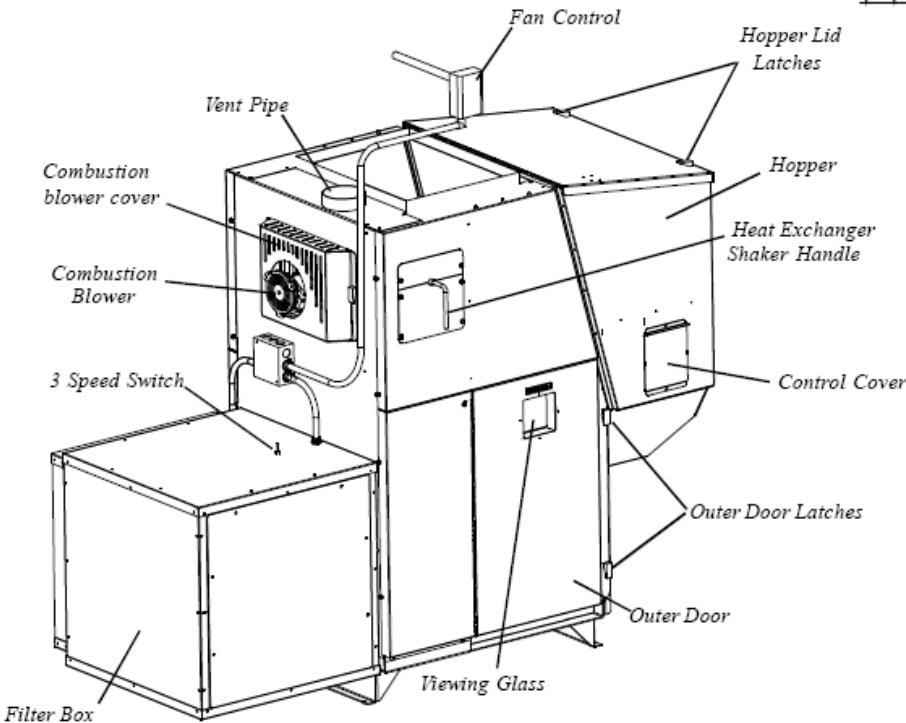

### Clearances

Rear	1 inch
Side	12 inches
Front	1 inch